

ForestEDWest 2008

A Conference Dedicated To Forest Education In Western Canada

CONFERENCE PROGRAM

January 24-27, 2008

Manteo Resort

Kelowna, BC

Embracing our Landscape

FORESTEDWEST

www.forestedwest.ca





TABLE OF CONTENTS

Welcome	4
Steering Committee	5
Sponsors	6
Announcements	7
Thursday January 24	7
Manteo Resort Map and Floor Plan	8
Conference at-a-Glance	9
Friday January 25	10
Saturday January 26	12
Sunday January 27	14
Friday Panelists	15
Saturday Panelists	16
Concurrent Session Abstracts	17
Friday Sessions	17
Saturday Sessions	22



WELCOME TO FORESTEDWEST™ 2008

The 2008 Conference Co-Chairs extend a warm welcome to all delegates and speakers to ForestEDWest in Beautiful British Columbia. We take tremendous pleasure in bringing together friends and colleagues to join us in Embracing our Landscape! Surrounded by the beauty and diversity of BC's ecosystems, in the tradition of ForestEDWest, as set by the founding conference chairs Steve McIsaac and Alex Drummond, we continue to explore forest and landscape education, sharing success stories and solutions for improvement.

As many of you know from our previous events, ForestEDWest is as much about attending workshops and sessions as it is about networking and connecting with colleagues and friends. So, we encourage you to attend all of the morning panels and break-out sessions. We have done our best to bring you a variety of presenters with topics that support our 2008 theme Embracing our Landscape.

Delegates from K-12 education, post-secondary institutions, education associations, government and industry have come from across Canada and the US contribute to the flavour of our event, and provide a unique opportunity for sharing of best practices and conversations on solutions to challenges in our varied fields of interest.

We would like to thank everyone who has come to ForestEDWest 2008 and wish you a great conference.

This conference would not be possible without the tremendous support we have received from our sponsors. We would like to thank the companies, associations and government ministries who recognize the value of forest and landscape education in Western Canada. Please see a full list of our sponsors on page 6.

Finally, we would like to thank all of the members of the volunteer steering committee who have worked together for the past year and a half to make this event what you see today.

Once again, thank you to everyone for joining us in Beautiful British Columbia at the Manteo Resort - have a great conference!

Sincerely,



Debbie Sluggitt

A handwritten signature in black ink that reads "DC Sluggitt".



Sandy McKellar

A handwritten signature in blue ink that reads "Sandy McKellar".

THE 2008 STEERING COMMITTEE

Thank you to everyone who contributed their time and energy on the Steering Committee. On top of 'real jobs' and busy lives, the following individuals committed many hours to make the 2008 conference a success - thank you to everyone for your hard work.

ForestEd West Conference Committee

Conference Co-Chairs

Debbie Sluggett
Sandy McKellar

Founding Conference Co-Chairs

Alex Drummond
Steve McIsaac

Committee Co-Chairs

Peter Barss & Helena Jehnichen & Chris Lear	Program
Candace Parsons & Brad Techy	Sponsorship
Debbie Bazett & Kalon Nahachewsky	Venue / Trade Show
Parker Hogan & Denise Leech	Communications
Steve Baumber & Chris Lear	Audio Visual

Committee Members

Susan Bondar
Colleen Cuthbert
Wayne Lintott
Jennifer Stewart

THANK YOU 2008 SPONSORS

We couldn't do it without you!

The ForestEDWest Co-Chairs and Steering Committee express the gratitude of all conference delegates to the following organizations without whose support this conference would not have been possible.

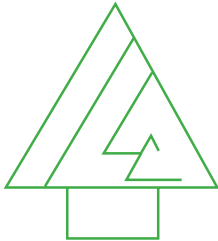

Interior Logging Association



Forestry Innovation Investment

We acknowledge the financial support of the Province of British Columbia through the Ministry of Forests and Range and Forestry Innovation Investment



West Fraser Mills Ltd



The Best Place on Earth

We acknowledge the financial support of the Province of British Columbia through the Ministry of Education



Louisiana Pacific



ANNOUNCEMENTS

CONCURRENT SESSIONS

Friday and Saturday will each feature three concurrent break-out sessions. Each session is 75 minutes long and will showcase two to three topics. The presentations have varying time frames, and therefore, we kindly request (in consideration of our speakers and audience members) that you remain in your session of choice for the full 75 minute session.

The program committee has made every effort to place complementary speakers together into each concurrent session. This was not an easy task and we apologize in advance if we have not met your needs.

The structure of the session will generally be a panel discussion with question and answer opportunities during the last 10 - 15 minutes of the session.

Due to printing deadlines, not all session descriptions that follow will have full presentation abstracts. Updated supplementary information will be provided in your delegate package if possible.

All conference sessions will be held at the Manteo Resort, breakout rooms will be clearly labeled on site.

LOOK FOR THE FEW VOLUNTEERS

If you need assistance or have any questions during the event - just look for a member of the FEW Steering Committee and we will do our best to help you or redirect you. Volunteers will be wearing tan FEW vests.

BREAKFAST AT MANTEO

Conference delegates that are registered guests at Manteo are invited to join us each morning for a breakfast service that has been included in your room rate.

Those delegates not staying at Manteo will need to make alternate arrangements.

THURSDAY JANUARY 24TH

Registration

noon - 9:00 p.m.

Hotel Lobby

Exhibitor Set-Up

noon - onward

Hotel Lobby

Wine and Cheese Reception

7:00 p.m. - 10:00 p.m.

Manteo Clubhouse

MANTEO RESORT FLOOR PLAN

The conference will take place across two locations at the resort. Please familiarize yourself with the property.

Breakfast will be served in the Clubhouse, and break-out sessions will be held in the main building's waterfront ballrooms.

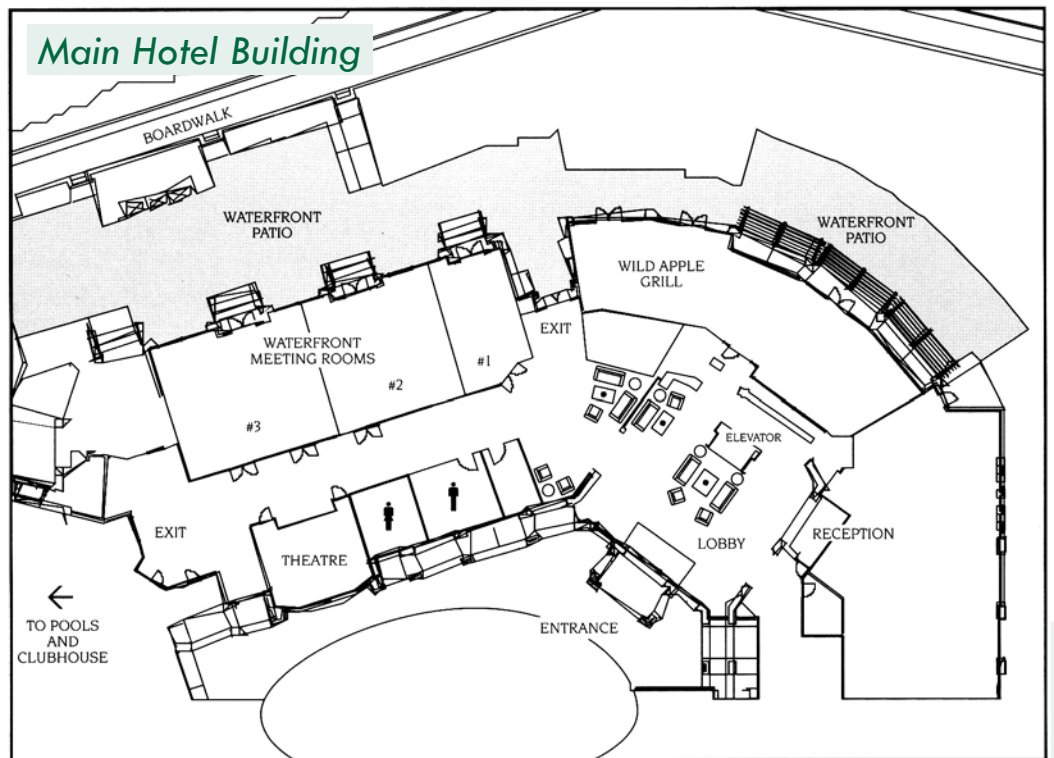
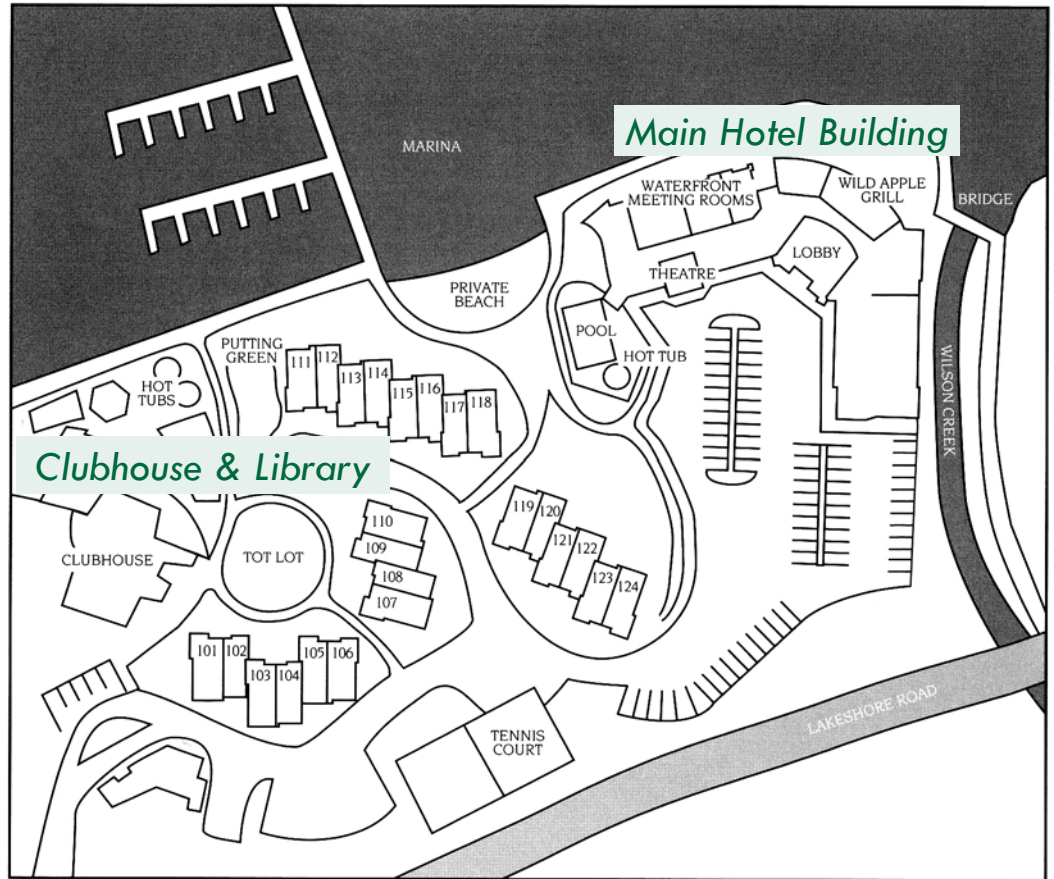

CONFERENCE AT-A-GLANCE

FRIDAY AT-A-GLANCE

Time	Event	Location
7:00 - 8:00	Breakfast Buffet (registration desk open at this time)	Clubhouse
8:15 - 9:00	Opening Introduction & Official Welcome	Ballroom
9:00 – 10:15	Embracing our Landscape Panel	Ballroom
10:15 - 10:45	Nutrition Break	Lobby
10:45 - noon	Concurrent Sessions (F1)	See on-site signage
noon - 13:15	Lunch	Clubhouse
13:15 - 14:30	Concurrent Sessions (F2)	See on-site signage
14:30 - 14:45	Energy Break	Lobby
14:45 - 16:00	Concurrent Sessions (F3)	See on-site signage
16:30 – 22:00	Travel to Silver Lake for Dinner & Entertainment	Silver Lake Camp

SATURDAY AT-A-GLANCE

Time	Event	Location
7:00 - 8:15	Breakfast Buffet	Clubhouse
8:30 - 8:45	Opening Introduction	Ballroom
8:45 – 10:00	Forests and Climate Change Panel	Ballroom
10:00 - 10:30	Nutrition Break	Lobby
10:30 - 11:45	Concurrent Sessions (S1)	See on-site signage
11:45 - 13:00	Lunch	Clubhouse
13:00 - 14:15	Concurrent Sessions (S2)	See on-site signage
14:15 - 14:45	Energy Break	Lobby
14:45 - 16:00	Concurrent Sessions (S3)	See on-site signage
18:30 – midnight	Banquet and Dance	Ballroom

SUNDAY AT-A-GLANCE

Time	Event	Location
8:30 - 9:30	Breakfast Buffet and Market Place	Ballroom
10:00 – 10:45	The Kelowna Forest Fires - BC Fire Protection Branch	Ballroom
10:45 - 11:30	ForestEDWest Summit III	Ballroom

FRIDAY AT-A-GLANCE

Time	Event	Location
7:00 - 8:00	Breakfast Buffet (registration desk open at this time)	Clubhouse
8:15 - 8:50	Opening Introduction & Official Welcome	Ballroom
9:00 – 10:15	Embracing our Landscape Panel	Ballroom
10:15 - 10:45	Nutrition Break	Lobby
10:45 - noon	Concurrent Sessions (F1)	See on-site signage
noon - 13:15	Lunch	Clubhouse
13:15 - 14:30	Concurrent Sessions (F2)	See on-site signage
14:30 - 14:45	Energy Break	Lobby
14:45 - 16:00	Concurrent Sessions (F3)	See on-site signage
16:30 – 22:00	Travel to Silver Lake for Dinner & Entertainment	Silver Lake Camp

FRIDAY PLENARY SESSION

Official Conference Opening and Welcome | 8:15 am | Ballroom

A welcome address from the conference Co-Chairs

Embracing our Landscape

Opening Keynote Panel Address - | 9:00 am to 10:15 am | Ballroom

Panelists will provide an overview of Canada's forest sector and the challenges we face today in education and communication.

Panelists

Andrew Casey, Forest Products Association of Canada, Ottawa, ON

Alex Drummond, University of Alberta & Steve Baumber, Consultant

FRIDAY EVENING EVENT

Friday night's event will see delegates bussed from Manteo Resort to the beautiful new camp lodge at Silver Lake Forestry Centre above Peachland for wine-tasting and a buffet dinner followed by entertainment from country singer and recording artist Lee Dinwoodie and his band.

Buses have been arranged to take delegates to the camp and will return to Manteo at the close of the evening. The event is an indoor casual event.

All delegates are to meet in the Manteo hotel lobby at **4:30 pm sharp** to board the buses.

FRIDAY SESSIONS

Time	Event	Title
10:45 - noon		
Concurrent Sessions (F1)		
Session F1A	John Davies (45 minutes)	Wildlife Management: Where are we going
	Steve Schell (30 minutes)	Careers in the BC Forest Service Protection Program
Session F1B	Treena Hein (45 minutes)	Canada's Forests Teaching Kits
	Bob Austman (30 minutes)	Saving Species at Risk: It Starts in Your Classroom
Session F1C	Kelly Hatfull (45 minutes)	Introducing the Forestry Camp: Teaching Forestry in the Forest
	Allison Campbell Urness (15 minutes)	EECO Heroes – Environmental Educators in the Central Okanagan
13:15 - 14:30		
Concurrent Sessions (F2)		
Session F2A	Rob Kennett (30 minutes)	Mountain Pine Beetle in the Okanagan Timber Supply Area
	Sandy McKellar & Dwight Yochim (45 minutes)	Taming the Monsters in the Forest (Festival of Forestry)
Session F2B	Janet Dean (45 minutes)	How to Work with and Engage the Young Nexus Generation Worker
	Wayne Lintott (15 minutes)	Forest Education Van - Traveling Education
	Donna Lawrence (15 minutes)	Boreal Range Resource Management Program
Session F2C	Jennifer Stewart & Kalon Nahachewsky (30 minutes)	Forest Education in the Okanagan - Columbia: Linking industry and schools in providing quality forest education.
	Ann Polson & Betty-Ann McDonald (30 minutes)	Forest Awareness Through Education - The Canadian Women in Timber
14:45 - 16:00		
Concurrent Sessions (F3)		
Session F3A	Lisa Leonard (30 minutes)	Teacher Forestry Tours: Once the tour is over
	Aaron Jones (30 minutes)	The Foothills Model Forest - Research being put into practice.
Session F3B	Tim Brigham (30 minutes)	Non-Timber-Forest-Products
	Kevin Davie (30 minutes)	Community Forests and Community Education go hand in hand.
Session F3C	Cynthia Kaufmann (30 minutes)	Research Partnerships for Better Questions and Useful Answers.
	Chris Lear & Chris Mushumanski (30 minutes)	Career Awareness Programs that Work

SATURDAY AT-A-GLANCE

Time	Event	Location
7:00 - 8:15	Breakfast Buffet (Manteo guests only)	Clubhouse
8:30 - 8:45	Opening Introduction	Ballroom
8:45 - 10:00	Forests and Climate Change Panel	Ballroom
10:00 - 10:30	Nutrition Break	Lobby
10:30 - 11:45	Concurrent Sessions (S1)	See on-site signage
11:45 - 13:00	Lunch	Clubhouse
13:00 - 14:15	Concurrent Sessions (S2)	See on-site signage
14:15 - 14:45	Energy Break	Lobby
14:45 - 16:00	Concurrent Sessions (S3)	See on-site signage
18:30 - midnight	Banquet and Dance	Ballroom

SATURDAY PROGRAM

Opening Address | 8:30 am | Ballroom

Welcome and remarks from FEW Founders Steve McIsaac and Alex Drummond

Forests and Climate Change

Opening Keynote Panel Address - | 8:45 am to 10:00 am | Ballroom

This panel presentation will focus on one of today's hot topics - climate change and green solutions. Speakers will address theories on climate change and predictions for the future, the impacts that these changes are having on our ecosystems, and green building solutions targeted at reducing greenhouse gas emissions and concentrating carbon in wood and wood products.

Panelists

Kelly McCloskey, Kelly McCloskey and Associates, Vancouver, BC

Richard Hebda, Royal BC Museum, Victoria, BC

Allan Carroll, Pacific Forestry Centre, Victoria, BC

SATURDAY BANQUET AND DANCE

6:30 pm - midnight

ForestEDWest's Saturday night banquet will be held in the ballroom at Manteo Resort, where delegates will enjoy a buffet dinner followed by entertainment and dancing to the ever-popular music of local Okanagan band the Young 'Uns.

Put on your dancing shoes, and prepare to have an FEW-good time!

SATURDAY SESSIONS

Time	Event	Title
10:30 - 11:45	Concurrent Sessions (S1)	
Session S1A	Blue Lake, Silver Lake, Evans Lake and Gavin Lake (45 minutes)	BC's Forest Education Centres - Places to Learn in Nature's Classroom.
	Paul Bohnert (30 minutes)	Growing from the Ground Up
Session S1B	Parker Hogan(45 minutes)	Green Side Up: The Continuing Need for Forest Educators
	Aaron Jones (30 minutes)	Forest Industry / Environmental Groups - Why can't they just get along?
Session S1C	John MacDonald (30 minutes)	The Virtual Forest Classroom. Case study of the new on-line wood processing diploma.
	Chris Mushumanski (30 minutes)	Hands on forest education: Growing Success!
13:00 - 14:15	Concurrent Sessions (S2)	
Session S2A	Paul Willms (30 minutes)	Aboriginal Participation in the British Columbia Natural Resources Sector
	Trevor Sandwell (30 minutes)	WoodLINKS! High school wood manufacturing program.
Session S2B	Ian Wilson (30 minutes)	Careers in Urban Tree Care: Aborigiculture and Urban Forestry
	Ficus Chan (45 minutes)	A Metropolis in the Midst of Wilderness: Teaching Urbanites About their Natural Environment
Session S2C	Karen Haasjes (30 minutes)	Junior Forest Wardens Rebirth
	Cory Doll & Robin Danyluk (30 minutes)	Inform, Involve and Inspire
	Steve Schell (15 minutes)	Adopt a Forester Forest Education Program
14:45 - 16:00	Concurrent Sessions (S3)	
Session S3A	David Rauscher & Erin Gluck (30 minutes)	Inside Forest Education
	Lisa Marak & Susan Bondar (30 minutes)	Small Scale Forestry – Woodlot Licenses as an Educational Tool
Session S3B	Wael Afifi (30 minutes)	The Integrated Resource Package for Resource Science 11/12
	Les Josza (45 minutes)	Wood Magic Show - Teaching Teachers
Session S3C	Judson Beaumont (45 minutes)	Bending the Rules
	Dave McDonald (30 minutes)	The CREW Alternative Program

SUNDAY AT-A-GLANCE

Time	Event	Location
8:30 - 9:30	Breakfast Buffet (Manteo Guests Only)	Ballroom
10:00 - 10:45	The Kelowna Forest Fires - BC Fire Protection Branch	Ballroom
10:45 - 11:30	ForestEDWest Summit III	Ballroom

SUNDAY PROGRAM

The Kelowna Fires | 10:00 am to 10:45 am | Ballroom

“2003 Fire Season”

Denis Gaudry is the Fire Center Manager over seven fire zones in BC's Southern Interior.

Gaudry's talk will touch on the following topics”

- the history of fire events in the region
- the conditions that led up to the large fire event in 2003
- the impact of the fires not only on the forest but also on the community
- the learnings from the fires and how the fire dept, forest protection, cities etc are working together to minimize the risk of such an event ever happening again
- stories from the frontlines of fighting the Kelowna fire

ForestED West Summit III | 10:45 am to 11:30 am | Ballroom

As per ForestEDWest tradition, the conference will conclude with a group discussion about the future of ForestED West and location of the 2010 conference. Discussion will be facilitated by Parker Hogan and Steve Baumber.



SPEAKER AND PRESENTATION ABSTRACTS

Friday Panelists

Andrew Casey - Vice President of Government Relations and Communications, Forest Products Association of Canada



Andrew Casey will speak to the industry's competitiveness in the new global economy and share key findings and recommendations from the Forest Products Industry Competitiveness Task Force Report. He will highlight the need for the industry to get its costs right, get industry structure right and get the future right in order to realize the emerging opportunities in the global forest and paper industry. Additionally, in an increasingly environmentally sensitive market place, Canada's strong environmental credentials are under-leveraged. Andrew will focus on the Canadian forest products industry's global leadership in sustainable forest management (SFM) and an environmental track record that can provide competitive advantage in the global market place. These opportunities offer a sustainable means of revitalizing one of Canada's most important industrial sectors which is of special importance to the self-sufficiency and economic well-being of hundreds of communities across rural Canada.

Does resource education in K to 12 classrooms translate into professionals looking after our valuable natural resources? Student numbers have dwindled in post-secondary forest education institutions across Canada as the careers available in the forest sector fell into obscurity in the minds of young people. The work of natural resource educational institutions has become the foundation of a renaissance in natural resource education. Success hinges on an integrated approach between K to 12 classrooms, post-secondary institutions, and the forest sector. Join two idealists who will inspire and educate you on the latest efforts to support natural resource education across Canada.

Alex Drummond



Alex Drummond is a professor in the Dept. of Renewable Resources at the University of Alberta and teaches in the Forestry and Environmental Sciences Programs. He is responsible for all the field schools in the two programs as

well as exposing students and the public at all levels to modern environmental forest management. Alex has had the lead responsibility for recruitment into the UofA's two Forestry programs for the last five years. Alex was the co-chair of the first two ForestEDWest Forest Education Conferences held in Banff in 2004 and 2006. His leadership in forest education and recruitment is also a valuable asset to a national recruitment effort he has been instrumental in managing.

Steve Baumber



Steve Baumber worked for six years in Kamloops with a growth and yield consultancy as part of their field staff and as a project manager. He then moved to Vancouver and spent three years as the Forestry Recruitment Officer for the UBC Faculty of Forestry. He served

as a volunteer board member with the Festival of Forestry and Canadian Women in Timber and is currently a MSc (Forestry) candidate at the UBC Faculty of Forestry studying ethics and professional decision making. He is also under contract to assist the Recruitment Task Force, with members drawn from educational institutes, industry, government and associations in BC who have contributed seed money and/or staff time to address the impending forest sector labour shortages.

SPEAKER AND PRESENTATION ABSTRACTS

Saturday Panelists

Kelly McCloskey - President, Kelly McCloskey and Associates.



Forest management and responsible manufacturing of products for everyday use is not rocket science - its much more difficult than that!

Foresters have long managed our public lands for timber, wildlife, water, and people which is complex enough, but more recently the role that forests and wood products play in green building and climate change have been added to the mix. How do Canada's forest management practices and the products produced from them "measure up" for today's environmentally conscious consumer? This session shows how lifecycle analysis and computer models allow for managers to understand how forest management, the production of building products, and the construction of buildings impact the environment. Using wood might just be the best thing for our environment.

Richard Hebda - Curator, Royal BC Museum.

Turning up the Heat: Challenges and Opportunities of Climate Change



How much do we know about climate change? Is it all doom and gloom? In this session Dr. Hebda introduces us to the scientific nuts and bolts of climate change. Through examples drawn from BC and his extensive knowledge of biology, earth and ocean sciences and environmental studies, you'll be exposed to the strategies, knowledge and skills we have at our disposal to address the projected impacts of global climate change. The implications for forest management and carbon stewardship will also be reviewed.

Allan L. Carroll, Ph.D. - Research Scientist, Canadian Forest Service.

The Connection Between Climate Change and the Mountain Pine Beetle.



DETAILED ABSTRACTS FOR CONCURRENT SESSIONS

Friday Session F1 10:45 am to noon

F1A

Wildfire Management: Where are we going in this hand basket?

John Davies, RPF, Davies Wildfire Management

Forest management activities, urban development, fire suppression programs and the First Nation reservation system have resulted in the loss of 'healthy' wildfires from the landscape. As a result wildfire management has long been overlooked. This session will critically examine wildfire management, the need for a reintroduction of First Nations' traditional burning practices, and will also address the lack of fire-related education in forestry schools. The presentation draws on John's experience in wildfire and fuel management and his hundreds of hours of fighting fires. Participants will come away with a better understanding of fire behaviour to take back to their classrooms.

Careers in the BC Forest Service's Protection Program

Steve Schell, RPF, Ministry of Forests and Range Protection Program

Learn about the exciting career opportunities available in the Ministry of Forests and Range Protection Program. The mandate of the Protection Program is to provide wildfire management and emergency response support for the protection of life and assets, particularly in forests and grasslands. Other land users, private landholders and the public rely significantly on fire suppression efforts. The diverse protection program offers a number of career opportunities for anyone up for a challenging and rewarding career. Currently some of the projects the Protection Program is involved in are developing Community Wildfire Prevention Plans and implementing operational treatments to reduce the risk and threat of wildfires.

F1B

Canada's Forests Teaching Kits

Treena Hein, Canadian Forestry Association

Come and be introduced to Canada's Forest Teaching Kits which are sure to find a special place in your classroom! The Canadian Forestry Association (CFA) proudly produces these kits for the use of classroom teachers and other educators across Canada. These bilingual, balanced and user-friendly kits are available on-line, with some editions still available in print. The topics of the eight kits range from wetlands and climate change to endangered species and forest heritage. Each kit is scrutinized by an editorial board that includes educator input, and the latest volumes explore the topical issues and values of the boreal forest.

Saving Species at Risk: It Starts from Your Classroom

Bob Austman, Manitoba Model Forest

We can all make a difference in the recovery of a threatened species. Education helps to increase the awareness of the plight of species at risk and encourages people to become active participants in the recovery process, such as reporting sightings. This session showcases curriculum support materials produced in Manitoba to draw attention to the Boreal Woodland Caribou. The materials include a DVD documentary entitled "Shadows of the Forest", a Teacher's Curriculum Package including lesson plans, answer keys, and a board game to illustrate the variety of challenges facing the Woodland Caribou as it moves from summer to winter range.

Friday Session F1 10:45 am to noon continued ...

F1C

Introducing the Forestry Camp: Teaching Forestry in the Forest

Kelly Hatfull, British Columbia Institute of Technology

How do you inspire your students with a passion for the great outdoors? The influence of forestry is felt everywhere in Western Canada and yet the broad range of education and careers available often falls under the radar screen of most young people. In this session examples and stories are used to highlight a three-day workshop delivered in the relaxing solitude of a managed forest outside of Vancouver. The camp focuses on using all our senses and sciences to learn basic forestry concepts. Hands-on activities are tempered with just enough indoor instruction to prepare students for the outdoor experience.

EECO Heroes – Environmental Educators in the Central Okanagan

Allison Campbell Urness, City of Kelowna

EECO Heroes is made up of a team of City of Kelowna employees from the Environment and Transportation Divisions, Regional Parks, Regional Waste Reduction Office and Watersmart who have been offering free environmental presentations in the Central Okanagan for more than a decade. This presentation will highlight some of the successful programs and events EECO Heroes uses to engage residents of the central Okanagan in environmental stewardship. Some of the imaginative programs offered are modelled after popular reality-TV shows such as Fear Factor and the Amazing Race and they also host the Environmental Mind Grind!

Friday Session F2 1:15 pm to 2:30 pm

F2A

Mountain Pine Beetle in the Okanagan Timber Supply Area

Robert Kennett, Tolko Industries Ltd, Okanagan Regional Woodlands

British Columbia is experiencing a severe mountain pine beetle epidemic with a magnitude that has not been previously recorded. In this session, the presenter will discuss the epidemic in the context of the Okanagan Timber Supply Area and provide information on infestation levels and the expected impacts on timber supply and non-timber resources, including hydrological, wildlife, and visual quality. The planning and harvesting techniques being used to mitigate the impact of the beetle will also be outlined.

Taming the Monsters in the Forest: The Festival of Forestry Teachers' Tours

Sandy McKellar & Dwight Yochim, Co-Chairs of the Festival of Forestry

This session highlights the Festival of Forestry (FoF) a non-profit society run by dedicated volunteers in Vancouver to provide a high quality professional development opportunity for teachers based in southwest BC. Teachers have been flown into some of BC's smallest communities to explore the issues of sustainable resource management. Thanks to a network of forest sector partners these forest tours and excursions are FREE to teachers who want to participate. Over two days teachers meet with forest professionals, First Nations leaders, environmental specialists, biologists and local community representatives. Bring the forest back to your classroom with this fabulous Pro-D opportunity.

Friday Session F2 1:15 pm to 2:30 pm continued ...

F2B	<p><i>How to Work with and Engage the Young Nexus Generation Worker</i> Janet Dean, President, Advanced Corporate Training Ltd.</p> <p>There are immense differences in how generations in today's workforce are managed – each of which has its own motivators, drivers, idiosyncrasies, traits and values. These subtle differences are intensely magnified when not paid attention to or not properly handled. One of the major challenges in managing the younger generations is that most of our human resource systems and procedures were built by and for the 'old guard.' By attending this interactive seminar, participants will hear how to better manage, motivate and engage young employees. Janet has demonstrated the critical ability to stimulate breakthrough thinking and execution in all four vital areas of performance enhancement: strategy, innovation, systems design and management.</p>
	<p><i>ILA Forest Education Van – A Traveling Education Resource</i> Wayne Lintott, President, Interior Logging Association</p> <p>This session will outline the planning and development of the Interior Logging Association's forest education van which travels BC introducing students and the general public to forestry. You will learn about how funds were raised and continue to be raised to cover the production and maintenance of the van, the goals that were set when developing the resources that were to be included in the van and the strategy that is followed when booking van visits to schools and public events. If you are looking for a new way to "reach out and touch" students and the public, this is a session you won't want to miss.</p>
	<p><i>Boreal Range Resource Management Program</i> Donna Lawrence, Provincial Range Management Specialist</p> <p>The Boreal Range Resource Management Program (BRRMP) within Alberta's Department of Sustainable Resource Development is responsible for developing ecologically-based forest grazing research and extension information and transferring this information to northern livestock producers to enhance the stewardship of public land grazing dispositions.</p>
F2C	<p><i>Forest Education in the Okanagan-Columbia</i> Jennifer Stewart and Kalon Nahachewsky</p> <p>Linking industry and schools in providing quality forest education: Jennifer and Kalon will provide an overview of the forest education programming in the Okanagan-Columbia area. They will outline the process of achieving positive links between industry and the education system while promoting current and relative forest education initiatives. They will discuss successes and provide attendees with tips on how to overcome difficulties that may arise when implementing a forest education program.</p>
	<p><i>Forest Awareness Through Education</i> Ann Polson & Betty-Ann McDonald, Canadian Women In Timber, Shuswap Branch</p> <p>Canadian Women In Timber (CWIT) is a non profit organization with active branches throughout BC whose central purpose is to educate the public about forests and the forest sector in a positive and factual manner. The Shuswap Branch of CWIT has developed a classroom presentation for K to Grade 7, and members volunteer their time to deliver it in local schools. Learn how CWIT's information and teaching resources, such as the "Fun In The Forest" activity book, can be adapted to different age groups, and experience their fun approach to discussing various subjects using props and hands-on teaching tools.</p>

Friday Session F3 2:45 pm to 4:00 pm

F3A

Teacher Forestry Tours: Once the tour is over...

Lisa Leonard, Temperate Forest Foundation

The US-based Temperate Forest Foundation (TFF) offers K-12 teachers forest educational products and professional development opportunities through its Teacher Forestry Tour programs. TFF's programs and materials were designed to provide teachers with a fundamental appreciation for the science and economic aspects of responsible forest management. This session will present new initiatives from the Foundation to continue to support teachers once the tours are over. This includes a new web-based resource which will connect educators, industry professionals, associations and the general public. It will also offer forest-related environmental curricula developed by science teacher participants from across North America.

The Foothills Model Forest – Research Being Put Into Practice

Aaron Jones, RPF, Stewardship, Public & Aboriginal Affairs, Hinton Wood Products

The Foothills Model Forest (FMF) is a non-profit organization with over 100 partners that conduct research into all aspects of sustainable forest management. Among its many programs, the FMF has the world's largest grizzly bear study, as well as research programs in natural disturbance, fish, watersheds, caribou, and Aboriginal consultation. Aaron will share the FMF's excellent working model that brings partners from a variety of backgrounds together to conduct research on issues affecting the sustainability of the forest and, most importantly, put that research into practice. This presentation will focus on a number of the multi-partner FMF's projects that, while somewhat controversial in nature, have produced spectacular results.

F3B

Non-Timber-Forest-Products

Tim Brigham, Centre for Non-Timber Resources

The Centre for Non-Timber Resources is the only organisation in Canada dedicated to NTFP research, education and development. Tim specializes in NTFP resource management - specifically inventory and compatible management – as well as capacity-building, community economic development and sector development. Learn how to incorporate these non-timber aspects of the forest in your classrooms and teaching materials.

Community Forests and Community Education go hand in hand.

Kevin Davie, Vice President, British Columbia Community Forest Association

Community forests are an important and growing opportunity for communities, supporting new options in recreation, wildlife and watershed management. Harvesting operations can also provide a source of revenue, supporting local priorities, while harvest rates and exact locations within the tenure can be set to meet locally determined objectives and interests. A community forest can be described as any forestry operation managed by a local government, community group, or First Nation for the benefit of the entire community. These forest lands also provide a unique learning environment where students and members of the public can engage directly with professionals in the forestry community, learning more about this valuable resource, and the jobs and economic support forestry can provide for all of us.

F3C

Research Partnerships for Better Questions and Useful Answers

Cynthia Kaufmann, Sustainable Forest Management Network

The Sustainable Forest Management (SFM) Network is a national interdisciplinary forest research network. The challenge of incorporating research results into meaningful management approaches and policy changes is a familiar one for Canada's forest sector. Forest research results are often highly technical and communicating this information to a diverse audience is challenging. The SFM Network uses an integrated research-knowledge exchange model, which asks both the researchers and the project partners to assume the responsibility for the knowledge exchange process (unlike traditional one-way 'extension' models). This session will provide some of the details of the SFM Network model of research-partner knowledge exchange.

Career Awareness Programs that Work

Chris Lear & Chris Mushumanski, COFI and School District No. 91 (Nechako Lakes)

This session will provide an overview of two successful career awareness programs developed for high school students and their teachers to highlight the career opportunities available in resource management and in the wood products manufacturing industry. Over the past six years these programs have reached out to hundreds of secondary school students, many of whom have gone on to enrol in post-secondary forestry and trades programs. In a unique dual-speaker presentation you will not only learn the details of the educational programs but also hear first-hand what the value was to students who benefited from the programs.

Saturday Session S1 10:30 am to 11:45 am

BC's Forest Education Centres- Places to Learn in Nature's Classroom

BC Forestry Kids Camp Joint Presentation

Educators who attend this session will come away with inspiring new ideas for forest education both in the classroom and the field. Representatives from four regional forestry education centres will present an overview of British Columbia's Independent Forest Education Centres. The four centres featured will be: Blue Lake Forest Education Centre (Kootenay), Silver Lake Forest Education Centre (Okanagan), Evans Lake Forest Education Centre (Coast Mountains) and Gavin Lake Forest Education Centre (Cariboo). Representatives from these centres will provide background on how each centre was established and an outline of the programs and special initiatives currently underway. They will also share their strategies for developing forest education content that is delivered to students in a residential camp setting.

S1A

Growing From the Ground Up

Paul Bohnert, Southern Alberta Community of Environmental Educators

The wild forest is an unknown place to many. We have disconnected from the natural classroom due to a lack of knowledge and experience with our woodlands. This session will rebuild your understanding of the forest where everything, including our own education, grows from the ground up. What are these vibrant ecosystems battling just to survive? How much do you know about current logging practices? Explore new mechanisms and resources to educate your students and the general public about forest practices and the wilderness outside our door awaiting our curiosity.

Green Side Up: The Continuing Need for Forest Educators

Parker Hogan, Alberta Forest Products Association

The public has taken the environmental message to heart and ideas like sustainability and environmental enhancement are becoming de rigueur. In this session the results of an online survey conducted for the Alberta Forest Products Association (AFPA) will be presented identifying what Albertans believed and valued about their forests. Despite their concerns, the largely urbanized public of the province are still relatively uninformed about the fundamentals of forestry. Forest educators are needed to better inform the public's concern for the environment. Learn how a balanced approach of economics, environment and social benefit is necessary in developing public understanding and acceptance.

Forest Industry/Environmental Groups - Why can't they just get along?

Aaron Jones, RPF, Stewardship, Public & Aboriginal Affairs, Hinton Wood Products

This presentation provides a forest industry viewpoint on why it is so difficult to work with some (not all) non-governmental environmental groups (ENGOS). While the public may wonder why these two groups can't just work out their differences, there are actually some very good reasons (which this presentation will delve into) why this proves to be so consistently difficult. These reasons centre around a number of widely varying factors including such things as the huge differential in the amount of resources each group has available, the funding mechanisms utilized by ENGOS, the business models of each organization, and the willingness to engage in public debate. The public (including teachers) are often left to wonder who to believe in the typical forest industry/ENGO confrontation. The intent of this presentation is to provide forest educators with some perspective on where each side is coming from, which hopefully will help provide some useful background when discussing these issues with students

S1B

Saturday Session S1 10:30 am to 11:45 am continued ...

S1C

The Virtual Forest Classroom. A case study of the new on-line Wood Processing and Management Diploma

John McDonald, British Columbia Institute of Technology

BCIT's Wood Products Manufacturing diploma program has moved from a full time, classroom-bound set of activities to a blended distance learning model. Multiple entry and exit points make training more accessible and affordable to communities where manufacturing actually takes place. The Industrial Wood Processing and Management program is predominantly on-line, with regular and frequent opportunities for interactive classroom instruction and some field trips. It removes the barriers of location and time which often prevents employers from supporting their workforce in further advancing their skills. This 'Just for You' model of training delivery is a fundamental aspect of BCIT's strategy for services to the wood and forest products industry. We will examine the logistics of delivering an online course/program.

Hands on Forest Education: Growing Success!

Chris Mushumanski, School District 91 Nechako Lakes

This presentation will highlight some of the ways all curricular areas can use forestry and a woodlot to enhance learning opportunities for students of all ages. School District 91 is home to a very successful high school forest education program hosted at Nechako Valley Secondary, in Vanderhoof, and Fort St. James Secondary in Fort St. James. Central to this program are two woodlots held by the school district and a non-profit education society. With these two woodlots, a very successful program has been built that has students from nearly every course area utilizing the woodlots at some point in their high school experience. Even Elementary school classes are active in the program.

Saturday Session S2 1:00 pm to 2:15 pm

S2A

Aboriginal Participation in the BC Natural Resources Sector

Paul Willms, Nicola Valley Institute of Technology

How can we inspire the inclusion of the Aboriginal Community in all levels of post secondary education and remove the barriers that hold some students back? The focus of this session will be to discuss how the Nicola Valley Institute of Technology (NVIT) has been building a foundation for the participation of the Aboriginal Community in the natural resources sector. The presentation will focus on the present and future program delivery methods that help to achieve a seamless progression for Aboriginal participants to enter trades, technical and professional careers ranging from basic entry level employment to professional and specialized positions.

WoodLINKS the Advanced Wood Manufacturing Education Program

Trevor Sandwell, Wood Manufacturing Council

WoodLINKS is an industry driven, entry-level certificate program that offers a BC Ministry of Education approved curriculum in advanced wood manufacturing. Updated in 2007, it consists of 120 course hours of training in basic and advanced wood manufacturing and eight specialized sub-sector components, ranging from sawmilling to fine woodworking. This new flexible model makes WoodLINKS suitable for First Nations and adult continuing education, industry in-house training and institutional instruction. The WMC also offers National Occupational Standards for wood machining operators, finishers, assemblers and in 2008, it will offer a supervisors standard.

Saturday Session S2 1:00 pm to 2:15 pm continued ...

S2B	<p><i>Careers in Urban Tree Care: Arboriculture and Urban Forestry</i></p> <p>Ian Wilson, Urban Forestry Supervisor, City of Kelowna</p> <p>Ian will present a short, nine minute video of career options in urban forestry/arboriculture. He will also share his own career path and answer the audience's questions.</p>
	<p><i>A Metropolis in the Midst of Wilderness: Teaching Urbanites About their Natural Environment</i></p> <p>Ficus Chan, esse environmental education & community development ltd.</p> <p>Metro Vancouver's Lower Seymour Conservation Reserve and Watershed Education Programs (www.gvrd.bc.ca/water) and the Gently Down the Seymour program for the Seymour Salmonid Society.</p>
S2C	<p><i>Junior Forest Wardens - A Rebirth</i></p> <p>Karen Haasjes, Junior Forest Wardens and BCTS</p> <p>Karen been involved with JFW for most of her life. She started when she was eight years old and has seen a lot of other kids grow up through the program. Karen will share her great experiences and memories from her time in Wardens and encourage others to take advantage of the program. Karen's experiences helped her to develop life skills and led to her career in forestry. Karen will review the JFW program and highlight some of the exciting changes that are coming to the program in BC.</p>
	<p><i>Inform, Involve and Inspire</i></p> <p>Cory Doll and Robyn Danyluk, Alberta Sustainable Resource Development</p> <p>How do you inspire an entire province of land and resource stewards? Alberta Sustainable Resource Development (SRD), coordinated through the Public Information, Education and Outreach unit, has a few good ideas. SRD works with Albertans to ensure a balance between the economic, environmental and social values of the province. This session will expand on their theme of "Informing, Involving and Inspiring" by providing examples about the programs and resources available from SRD to support school and community based educational programs in Alberta.</p>
	<p><i>Adopt-A-Forester Forest Education Program</i></p> <p>Steve Schell, RPF</p> <p>Steve will share the benefits of the Adopt-A-Forester program and offer advice on how you can start a program in your community. This program was established in 1991 in the Kamloops/Okanagan school District when a group of teachers and staff from the Ministry of Forests determined that teachers needed resources for delivering forestry education in the classroom. The Adopt-A-Forester program is a great resource for teachers who don't have access to funds to hire a forest educator because it provides teachers with access to a network of forest professionals who are enthusiastic about sharing their forestry knowledge and expertise to schools through field trips and presentations. These forest professionals guide students through an exploration of tree and plant life, forest dynamics, wildfire management, habitat management and ecological principles. Steve will provide an overview of this forest education programs and share the successes and challenges faced by unorganized communities.</p>

Saturday Session S3 2:45 pm to 4:00 pm

S3A

Inside Forest Education

Erin Gluck and David Rauscher, Inside Education

Inside Education is a not-for-profit natural resource and environment education society that has been delivering curriculum-based, multiple perspective programming for more than 20 years. In response to the ever-increasing demand for environment and natural resource education, Inside Education has launched two new initiatives to help deliver programs in areas that have historically been under-serviced by non-traditional education organizations. The Integrated Landscape Management Education Program, offered at junior and senior high schools, focuses on integrated land use by multiple users in Alberta's forested areas. The Boreal Education Strategy addresses the educational needs of small, rural and Aboriginal schools in Alberta's boreal region. Attendees at this session will learn about the successes and challenges of these new programs and discover new ways to provide forestry programming.

Small-Scale Forestry – Woodlot Licenses as Educational Tools

Lisa Marak and Susan Bondar

Discover the forestry learning opportunities available in a woodlot near you. A woodlot is a privately-owned plot of forest land and a woodlot licence is an agreement between an individual/organization and the BC government to manage a plot of Crown land often in combination with private land. Licensees represent groups who tend towards a personal, small-scale approach to resource management. Woodlot licensees can offer educational opportunities for your community, school or class. We will provide educators with a DVD that includes information about the value of woodlots for protecting forest values, providing integrated forest management and maintaining biodiversity. Included with the DVD is a classroom lesson complete with BC curricular connections.

S3B

The Integrated Resource Package for Resource Sciences 11/12

Wael Afifi, BC Ministry of Education

Participants in this session will get an opportunity to review the Response Draft for the new BC Ministry of Education Integrated Resource Package (IRP) for 'Resource Sciences 11/12'. Participants will also examine the various components of this new IRP. The session will provide a brief outline of the objectives of the courses, their structures, as well as the development process.

Wood Magic Show - Teaching the Teachers

Les Jozsa ("The Wood Guy")

The interactive presentation will deal with the form and structure of trees, logs, lumber, annual rings and wood fibres. In other words, wood quality issues which are important to foresters, loggers, log-home builders, furniture makers, and other users of wood. The presentation will cover a variety of issues related to wood and will be specially geared to teachers and how they can apply this information in their classrooms. Les is an entertaining and intelligent presenter who uses a wide variety of props and stunts to emphasize his learning objectives. Be ready to answer questions and actively participate in this workshop.

Bending the Rules

Judson Beaumont, President, Straight Line Designs Inc.

Judson Beaumont strives to make furniture and environments interesting, whimsical and fun! Creating one-of-a-kind furniture pieces out of wood, Judson designs pieces that are new, inspiring, and always very functional. In this session be inspired by his passion for 'something different', including plans for reusing the blue stained mountain pine beetle wood, recycling and incorporating it into his designs. As Judson says, "A person must dare to drift away from the tired and true. Be influenced and inspired by the norm, and then challenge it, change it, melt it, stretch it, alter it for the better."

S3C

The CREW Alternative Program

Dave McDonald

"CREW Alternative - A project-based learning proposal linking real world, hands-on activities in the local community with BC Ministry curricular objectives and outcomes." The CREW Alternative Program will offer a program of choice for students and parents who desire an educational program that centers on environmental values, team co-operation and "hands-on" skills training. This program will take students at their current academic and social skills level and provide them with the opportunity to build upon their individual strengths while working on areas requiring remediation. Students will be actively involved in many forestry and outdoor work projects. Proposed start-up is September 2008 targeted at Grade 9 students in Mission School District #75.





FORESTEDWEST

www.forestedwest.ca

